

NOTES:

1. REMOVE ALL LEAD AND OTHER FLASHING BEFORE INSTALLING PIPE SEAL.
2. TEMPERATURE OF PIPE MUST NOT EXCEED 180°F (82°C).
3. PRE-MOLDED PIPE SEAL MUST HAVE INTACT RIB AT THE TOP EDGE REGARDLESS OF PIPE DIAMETER.
4. INSTALL A MIN. OF 4 FASTENERS FOR PIPES WITH OUTSIDE DIAMETER <math><6''</math> (152mm). SEE DETAIL [VGMA-8.4](#) FOR WIDER PIPES.
5. DECK FLANGES OF THE QUICK-APPLIED PIPE SEAL SHALL NOT BE OVERLAPPED, CUT OR APPLIED OVER ANY ANGLE CHANGE.

DIMENSIONS	mm	
(A)	1/2"	13
(B)	6"	152 TO
	12"	305
(C)	2"	51
(D)	1/2"	13 TO
	6"	152

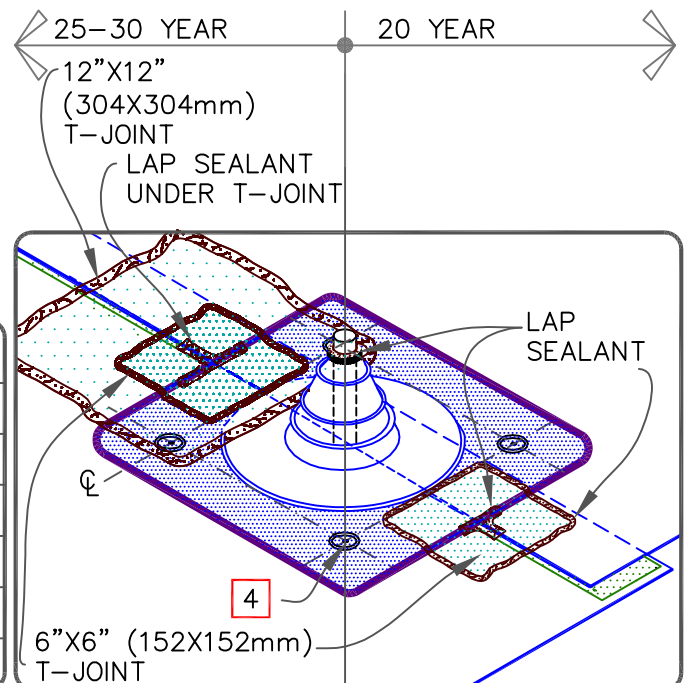

QUICK APPLIED PIPE SEAL WITH 20" QUICK-APPLIED CURED FLASHING

MECHANICALLY ATTACHED EPDM

**VGMA-8.3**